

24 Market Place, Bolsover, Chesterfield, S44 6PN
01246 822 138
enquiries@wilsonstateagents.co.uk
www.wilsonstateagents.co.uk



11 Haycroft Gardens
Chesterfield, S43 3FE

£750 PER MONTH

A two bedroom town house situated in the popular residential area of Mastin Moor, this property benefits from off road parking to the front of the property and an enclosed rear garden.

The modern kitchen comprises ample wall and base units and fitted oven hob and extractor, open plan lounge to the front, downstairs w.c. and two bedrooms and a bathroom upstairs.

This property is ideally located for commuting via the M1 motorway and close to local shops.

£750pcm £750 bond.

11 HAYCROFT GARDENS, CHESTERFIELD, S43 3FE



Ground Floor

Approx. 27.6 sq. metres (296.5 sq. feet)

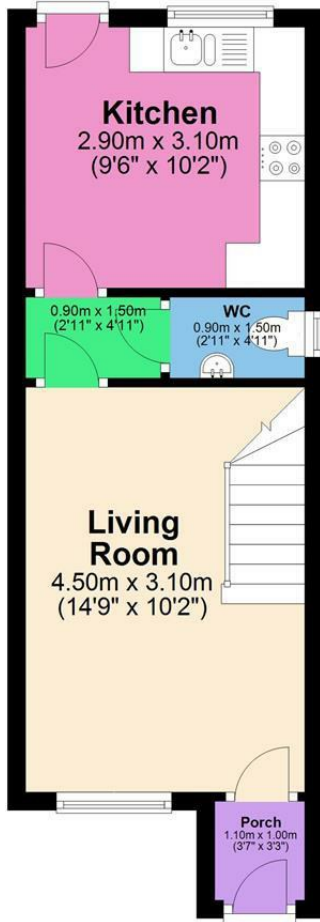

First Floor

Approx. 27.0 sq. metres (290.3 sq. feet)

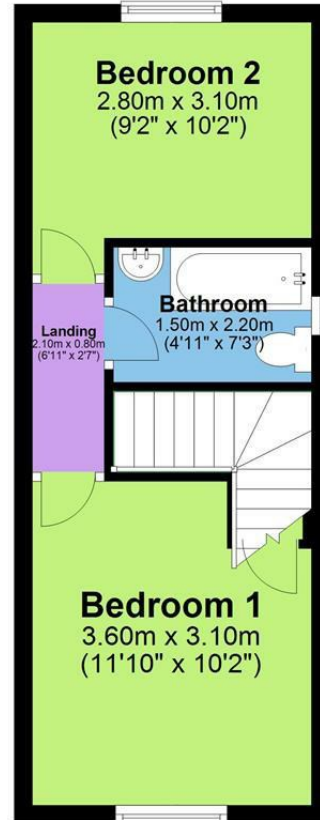

Total area: approx. 54.5 sq. metres (586.8 sq. feet)
11 Haycroft Gardens

Energy Efficiency Rating		Environmental Impact (CO ₂) Rating	
Current	Potential	Current	Potential
 Current: B Potential: A Score: 72	 Potential: A Score: 80	 Current: C Potential: B	 Potential: B
For energy efficient homes, higher ratings mean lower energy bills.		For environmental friendly homes, higher ratings mean lower CO ₂ emissions.	
England & Wales 2020/1/15		England & Wales 2020/1/15	